

Gaither[®]
PROFESSIONAL EQUIPMENT

**REACHING
FOR NEW
HEIGHTS!**

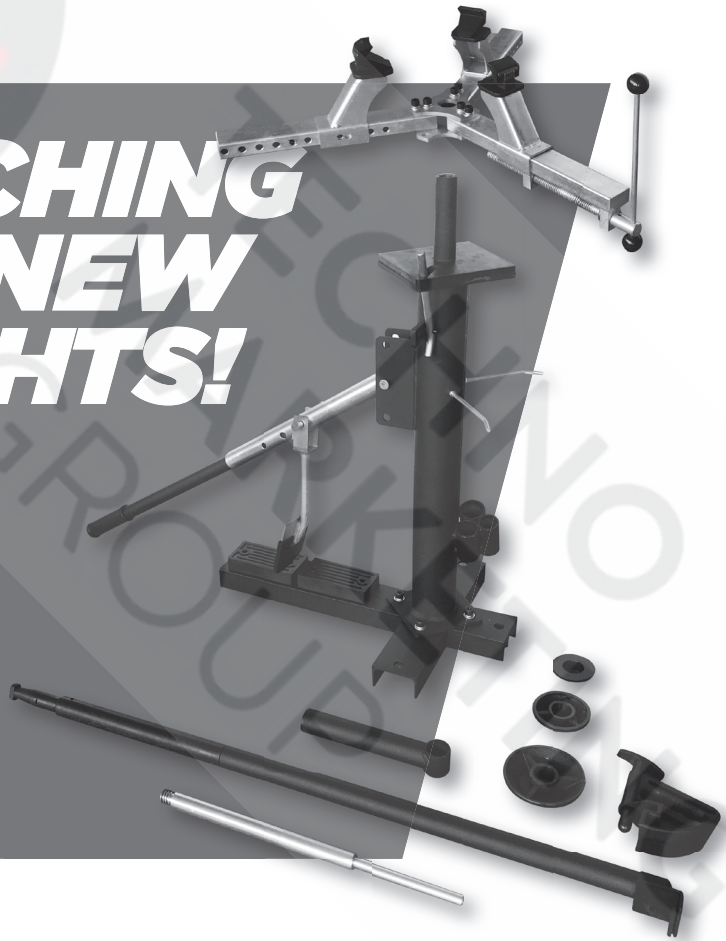

**INSTRUCTIONS FOR
MANUAL TIRE CHANGER 12772**

GAITHER 12772 MANUAL TIRE CHANGER



Thank you for purchasing a Gaither Tools product. Manufactured to a high standard this product will, if used according to these instructions and properly maintained, give you years of trouble free performance. The next generation 12772 manual tire changer offers a heavy duty design and all new clamping system. Equipped with a variety of accessories, this standalone, portable device can be operated easily without the need for electrical- or pneumatic power.

Due to its robust framework and tire mounting- and demounting lever it becomes possible to change a large variety of tires which sets it apart from alternatives in the market. The included adaptor ensures precise clamping and centering of wheels from 4"-21". The ideal solution while servicing motor cycle, scooter, ATV, car, racing and 4x4 tires.



IMPORTANT:

PLEASE READ THESE INSTRUCTIONS CAREFULLY. NOTE THE SAFE OPERATIONAL REQUIREMENTS, WARNINGS AND CAUTIONS. USE THE PRODUCT CORRECTLY AND WITH CARE FOR THE PURPOSE FOR WHICH IT IS INTENDED. FAILURE TO DO SO MAY CAUSE DAMAGE AND/OR PERSONAL INJURY AND WILL INVALIDATE THE WARRANTY. PLEASE KEEP INSTRUCTIONS SAFE FOR FUTURE USE.



MORE INFO AND INSTRUCTION VIDEOS VISIT GAITHERTOOL.COM

PARTS FOR 12772

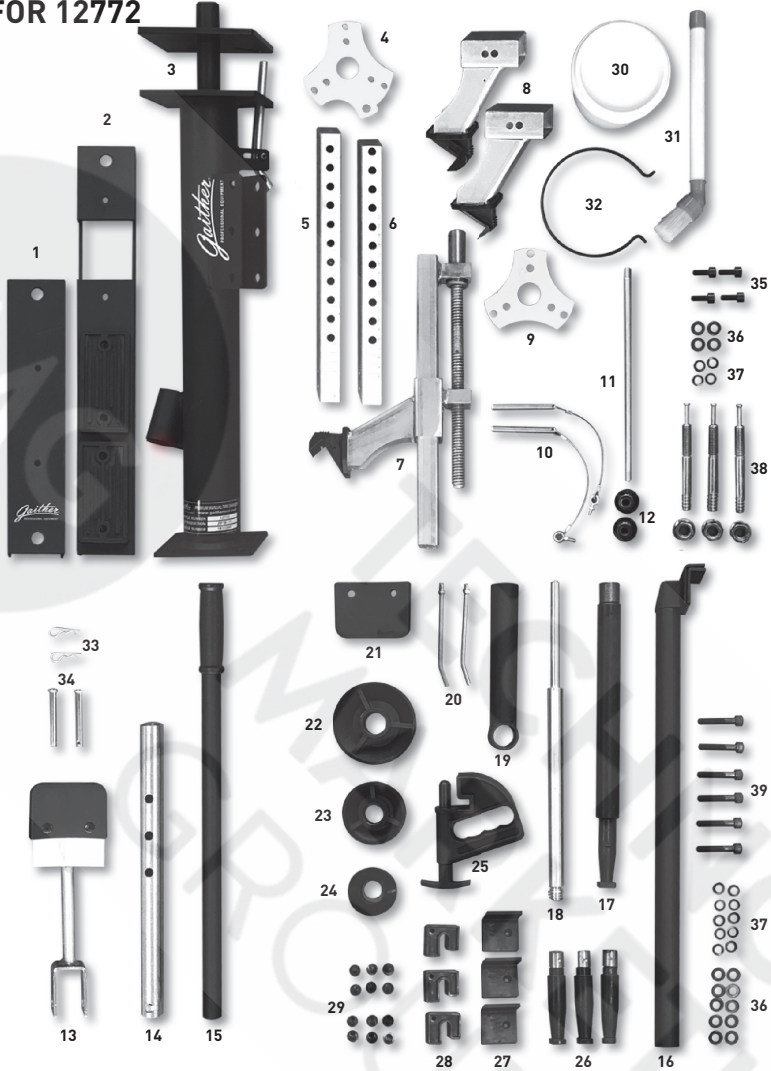

ITEM	ART. NR	DESCRIPTION	ITEM	ART. NR	DESCRIPTION
1	12772-1	BASE PLATE 1	21	12772-21	BEAD BREAKER PROTECTION
2	12772-2	BASE PLATE 2	22	12772-22	CONE 1
3	12772-3	CENTER POST	23	12772-23	CONE 2
4	12772-4	BOTTOM FLANGE ADAPTER	24	12772-24	CONE 3
5	12772-5	ADAPTER BAR	25	12772-25	BEAD KEEPER
6	12772-6	ADAPTER BAR	26	12772-26	DEMOUNT BAR PROTECTION 1
7	12772-7	ADJUSTING BAR INCL. CLAMP	27	12772-27	DEMOUNT BAR PROTECTION 2
8	12772-8	CLAMP	28	12772-28	BEAD PRESSING BLOCK
9	12772-9	UPPER FLANGE ADAPTER	29	12772-29	BEAD BREAKER PROTECTION PLUG
10	12772-10	CLAMP LOCKING PIN	30	12772-30	TIRE LUBRICANT BUCKET
11	12772-11	ADJUSTING ROD	31	12772-31	MOUNTING PASTE BRUSH
12	12772-12	KNOB	32	12772-32	BUCKET HOLDER
13	12772-13	BEAD BREAKER SHOE	33	12772-33	R-CLIP
14	12772-14	HANDLE SOCKET	34	12772-34	CLEVIS PIN
15	12772-15	BEAD BREAKER HANDLE	35	12772-35	HEX BOLT M10X20
16	12772-16	DEMOUNT BAR 1	36	12772-36	FLAT WASHER M10
17	12772-17	DEMOUNT BAR 2	37	12772-37	SPRING WASHER M10
18	12772-18	PIN	38	12772-38	EXPANSION BOLT M16X120 + NUT
19	12772-19	CENTER POST CAP	39	12772-39	HEX BOLT M10X50
20	12772-20	CONE STORAGE PIN			



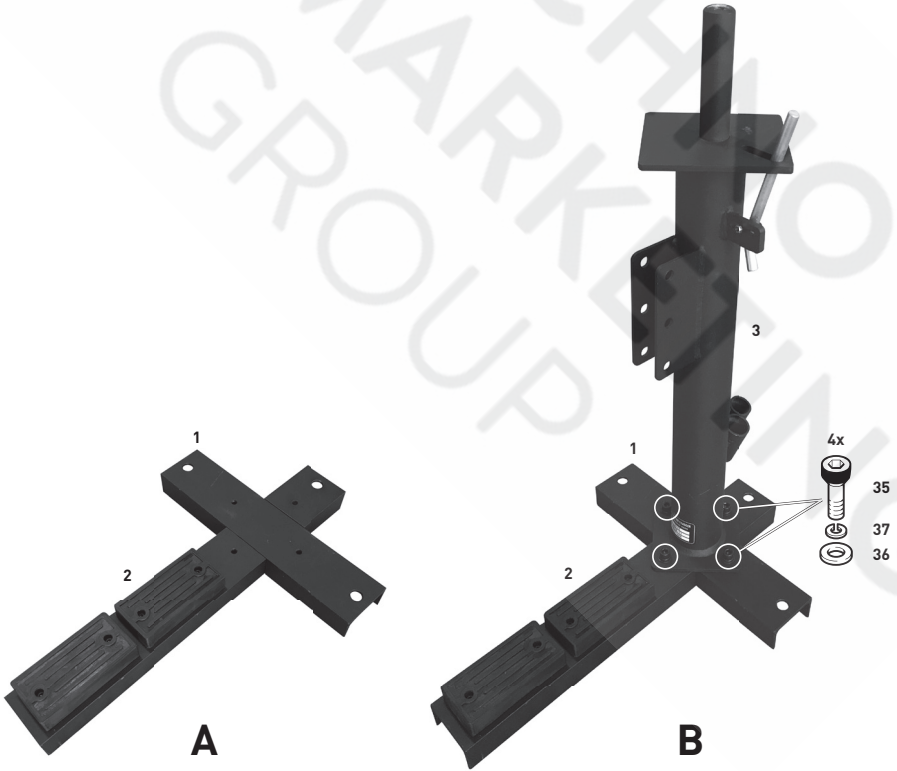
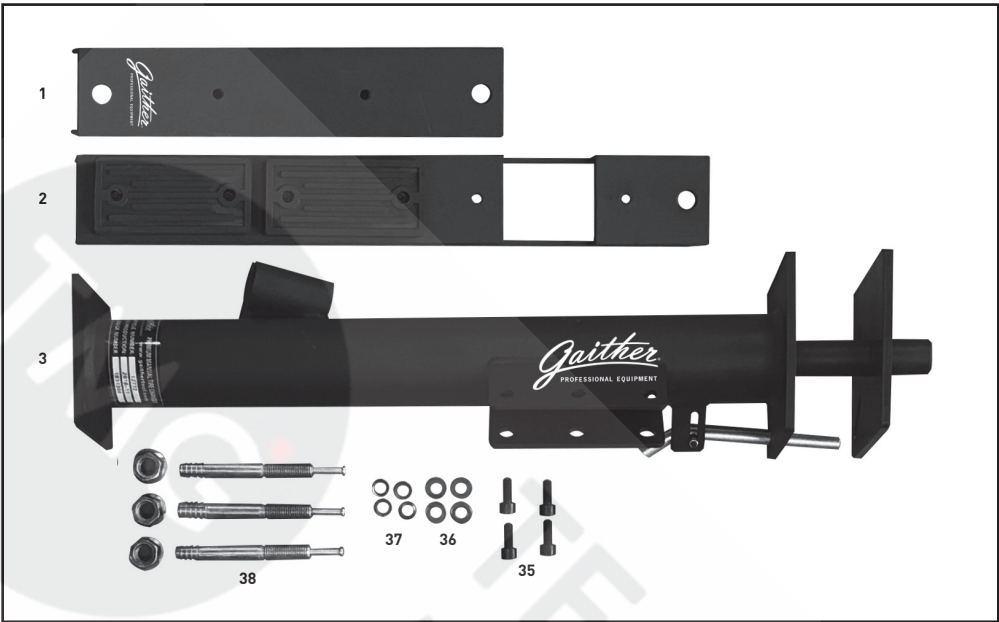

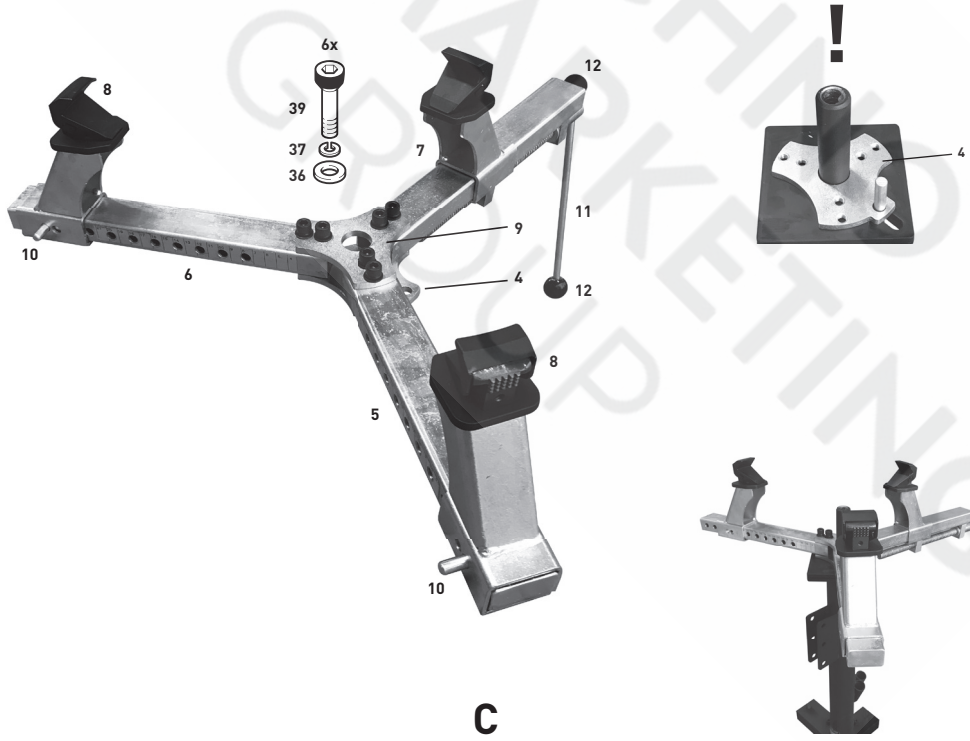
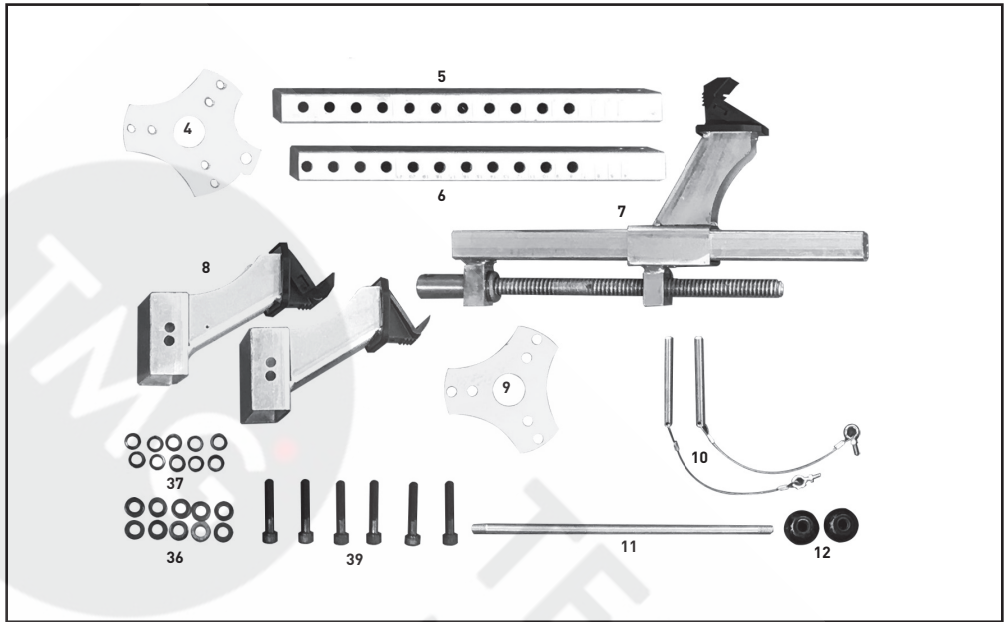

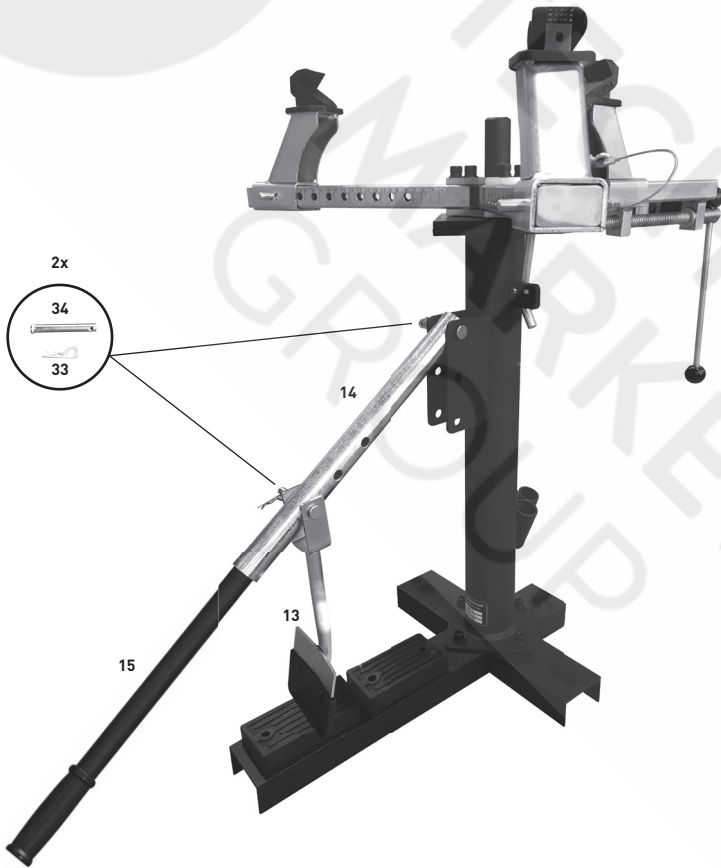
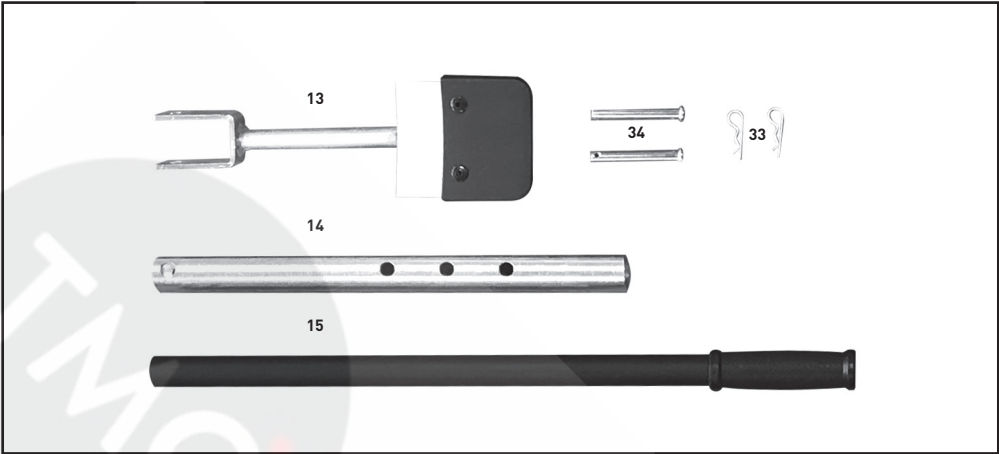

D

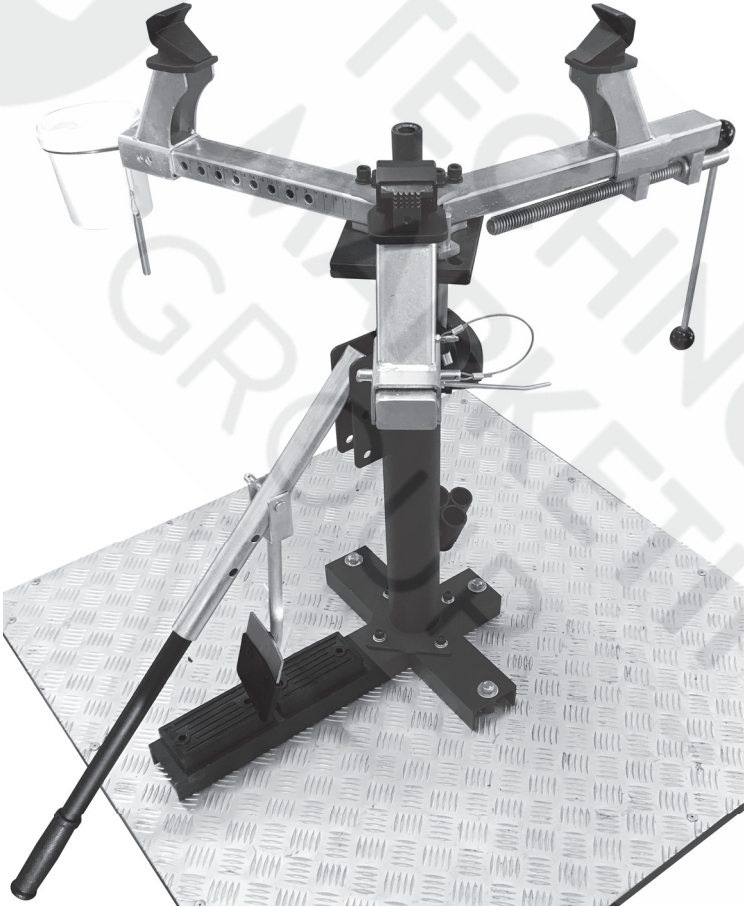
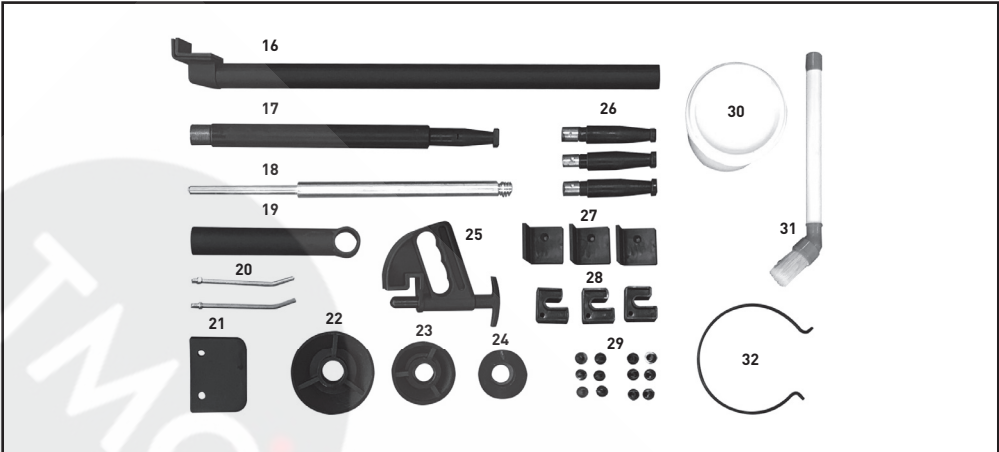

E

DEMOUNTING 1

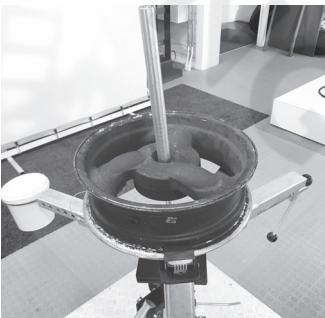
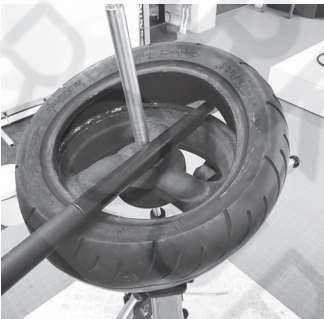
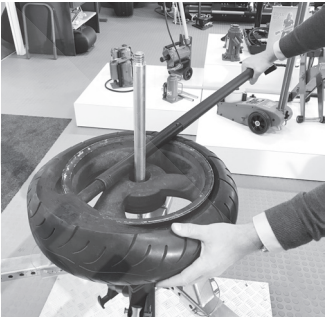
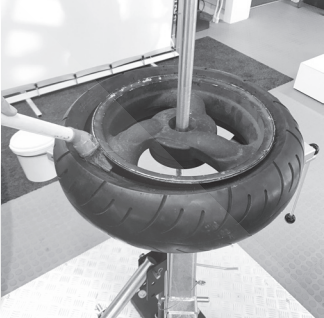
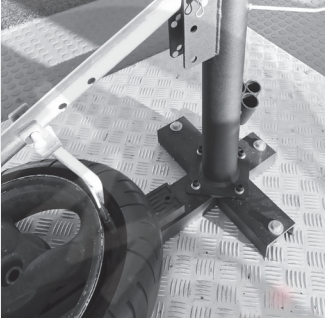

MOUNTING 1

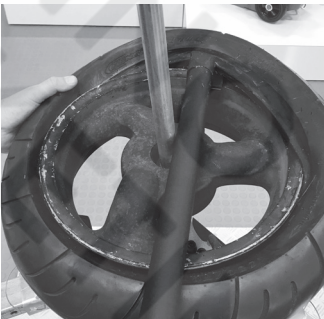
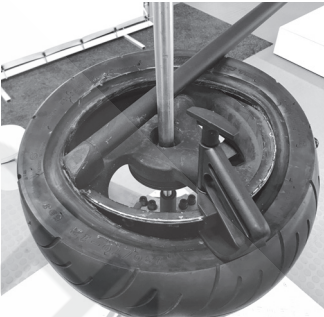
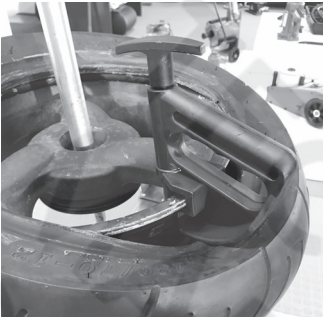
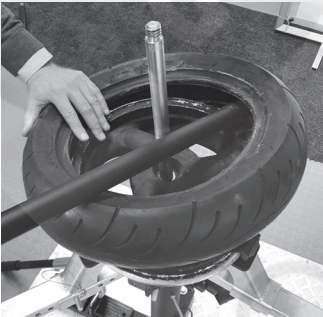
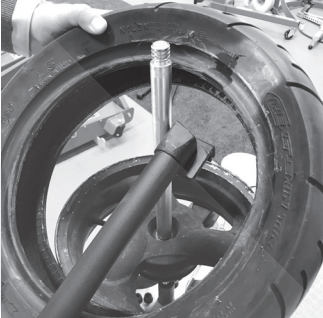
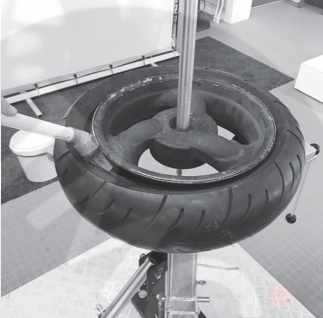

DEMOUNTING 2



MOUNTING 2



ABOUT US

Gaither Tool Company, Inc. founded in 1988, is an international organization committed to serving the tire and trucking industry. It invents and manufactures convenient tools and systems needed to service and maintain tires and wheel assemblies.

Gaither Tool Company, Inc. continually invests in research and development to bring to its customers the most effective tools in the business. It strives to improve efficiency and reduce costs for customers all over the world working in truck maintenance shops as well as on-the-road tire service providers. Bandag, Euromaster/Michelin, Bridgestone's First Stop, The United States Armed Forces... just to name a few.

Gaither supplies products to customers in over 100 countries, selling through exclusive and nonexclusive distributors. Gaither Tool Company, Inc. is headquartered in Jacksonville, Illinois, U.S.A. In 1997 it opened a branch office located in Roosendaal, Holland to better serve the European market. In 1999 that office was incorporated in Holland and Gaither Europe BV was started. Gaither's manufacturing plant and warehousing for International distribution is located in Taichung, Taiwan.

With a strategically placed location in both The United States and The Netherlands, we are able to serve the global industry



CONTACT US
gaithertool.com

GAITHER EUROPE BV
THE NETHERLANDS

Rechtzaad 6
4703 RC Roosendaal (Holland)

t +31 (0) 165 554475

f +31 (0) 165 391819

e evd@gaithereurope.com

Gaither
PROFESSIONAL EQUIPMENT

CHANGING THE WAY THE WORLD SERVICES YOUR TIRES